



## Universal Tower Bimini Top Parts List (UPS-Able)

Item	QTY Per Top	QTY with Single Brace Option	QTY with Double Brace Option
No. 8 Screws, 1/2" Length	16	16	16
No. 10 Screws, 1" Length	8	4	0
Finish Washer	4	2	0
Long, Metal Side Bow Sections	2	2	2
Medium, Metal Side Bow Sections	2	2	2
Short, Metal Side Bow Sections	2	2	2
Center, Metal Cross Bow Sections	3	3	3
Black Polypropylene Hold-Down Straps	4	2	0
Bimini Top Canvas	1	1	1
Bimini Top Storage Boot	1	1	1
Tower Clamps	2	4	6
Rubber Gaskets	2	4	6
Thumb Screws	2	4	6
1/4" Spacer (Used with Thumb Screws)	2	4	6
Allen Wrench	1	1	1
Eye Straps	4	2	0
24-inch Aluminum Braces	0	2	4
Hinged Jaw Slides	0	2	4

These instructions show how to assemble the top, with its frame and straps, starting upside down and inverting to an upright position when attaching to your boat.

**Step 1** - Spread the Bimini Top metal out on a flat, clean surface. All bows are color coordinated with stickers:

**A-Bow** - Red / **B-Bow** - White / **C-Bow** - Blue

**Step 2** - Identify the hook-shaped, long (A-bow), medium (B-bow), and short (C-bow) side frame parts. Using the 2 A-bow side frame parts, and the center (red sticker) for the A-bow, assemble the side bow and center bow parts as shown, aligning the pre-drilled holes. Matching the colored stickers, use the #8 x 1/2" screws to connect the bow parts securely.

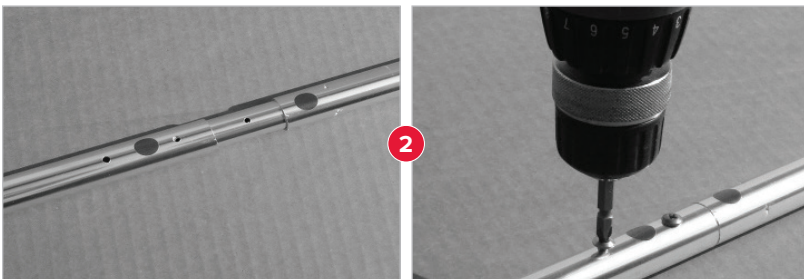

**Step 3** - Repeat this procedure for the medium (B-bow) and short (C-bow), aligning the pre-drilled holes and securing them with #8 x 1/2" screws,

**Caution:** If screw heads become burred, cover heads with duct tape to avoid damage to canvas.

**Step 4** - Pass looped end of each hold-down strap over each end of the long (A-bow) and medium (B-bow). Use a #8 x 1/2" screw to fasten strap to bow frame at each pre-drilled hole position as shown. Position strap over hole and insert screw, with finish washer, through center of strap and into pre-drilled hole. Be sure the adjuster buckle is facing out.

**Step 5** - With bows assembled, first pass long (A-bow) assembly through sleeve at the rear of the top. (This is the sleeve with the sewn-in tag.) Be sure jaw slides are facing down.

Pass the short (C-bow) assembly through the small center sleeve.

**Step 6** - Pass the medium (B-bow) assembly through the sleeve at the front of the top. Be sure screws for hold-down straps are facing down.

**Step 7** - Connect short (C-bow) frame ends to jaw slides on each side of long (A-bow) frame. Repeat for medium (B-bow) frame ends as shown. Jaw slides should allow short (C-bows) to pivot, but be tight enough to hold securely.

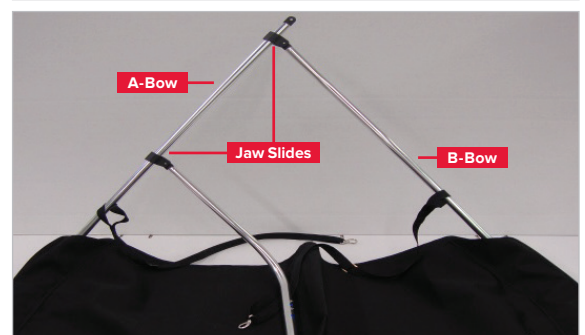
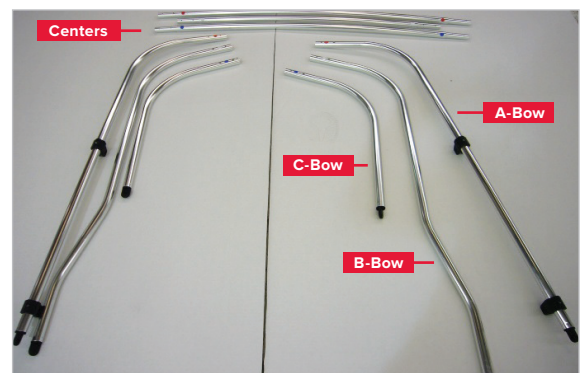
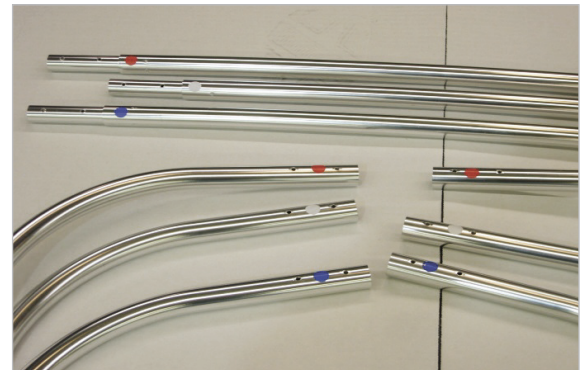



## Universal Tower Bimini Tops - Installation

1. Place the folded Bimini Top in the storage boot
2. Using the straps on the boot, secure the bimini to the top of the tower adjusting the straps to the desired storage height (typically beneath the speakers, if applicable).
3. Prepare to install the tower clamps. Clamps are standard 2-3/8" inside diameter. A 3-foot length of black rubber gasket is provided for each clamp. If the diameter of your tower is smaller than 2-3/8", wrap a sufficient amount of rubber gasket around the tower so that the clamp will fasten tightly around the tower leg. For 1-7/8" diameter towers, the entire 3-foot length of gasket will be used. For 2-3/8" tower diameter, a single wrap of gasket will help prevent the clamp from scratching the tower.
4. Using the Allen wrench provided, install the tower clamps on the rear tower legs parallel to the bottom fittings on the bimini frame. The tower clamps should be positioned with the thumb screw facing the inside of the boat. Since no drilling is required, the tower clamps may easily be adjusted as needed.
5. Using the thumb screws and 1/4" spacers provided, attach the bimini to the tower clamps and disconnect the boot straps so that the bimini drops to the rear. **Note: Each spacer should be positioned so that it rests against flat side of the tower clamp. This allows the eye end to rotate freely on the thumb screw.**
6. Unzip the boot and deploy the bimini. Pivot the bimini upward to install the adjustable hold-downs located at each corner of the Bimini Top.
7. Mark the position of the eye straps on the gunnel of the boat, measuring to make sure they are exactly opposite each other on each side of the boat. The position of the eye straps should be such that 45 to 90 degree angles are formed with the front and rear bow (a wide letter "M" as shown) when the hold-down straps are secured. Be sure to leave room for strap adjustment!
8. Use a drill with a 9/64" bit to drill the pilot holes for the eye straps. When drilling into fiberglass, be sure to hollow out the pilot holes slightly with the drill bit. Secure the eye straps with the No. 10 x 1" sheet metal screws provided. Attach the hold-down straps to the eye straps.
9. Adjust the bimini to the desired position by adjusting the front and rear hold-down straps. Make sure the canvas is as taut as possible to prevent loose fabric from whipping in the wind.
10. If you ordered brace options with your tower bimini, the braces are easy to adjust and install. All braces are 24" long, standard. To reduce the length of a brace, simply remove the eye end by loosening the set screw. Cut the brace to the desired length using a hacksaw and replace the eye end. Fasten the hinged jaw slide to the frame by tightening the set screw, and secure the eye end to the bolt on the jaw slide. Attach the opposite end of the brace to the tower with the tower clamp, spacer and thumb screw (refer to step 5), thumb screws toward the inside of the boat.



Tower Bimini, Stored Position



Placement of the hold-down straps should form the letter "M". Straps should form a 45 to 90 degree angle with each bow.



Optional braces are easy to adjust and install.



## Universal Tower Bimini Top Parts List (Pre-Assembled)

Item	QTY Per Top	QTY with Single Brace Option	QTY with Double Brace Option
No. 10 Screws, 1" Length	8	4	0
Black Polypropylene Hold-Down Straps	4	2	0
Bimini Top Canvas	1	1	1
Bimini Top Storage Boot	1	1	1
Tower Clamps	2	4	6
Rubber Gaskets	2	4	6
Thumb Screws	2	4	6
1/4" Spacer (Used with Thumb Screws)	2	4	6
Allen Wrench	1	1	1
Eye Straps	4	2	0
24-inch Aluminum Braces	0	2	4
Hinged Jaw Slides	0	2	4



1. Using the straps on the boot, secure the bimini to the top of the tower adjusting the straps to the desired storage height (typically beneath the speakers, if applicable).
2. Prepare to install the tower clamps. Clamps are standard 2-3/8" inside diameter. A 3-foot length of black rubber gasket is provided for each clamp. If the diameter of your tower is smaller than 2-3/8", wrap a sufficient amount of rubber gasket around the tower so that the clamp will fasten tightly around the tower leg. For 1-7/8" diameter towers, the entire 3-foot length of gasket will be used. For 2-3/8" tower diameter, a single wrap of gasket will help prevent the clamp from scratching the tower.
3. Using the Allen wrench provided, install the tower clamps on the rear tower legs parallel to the bottom fittings on the bimini frame. The tower clamps should be positioned with the thumb screw facing the inside of the boat. Since no drilling is required, the tower clamps may easily be adjusted as needed.
4. Using the thumb screws and 1/4" spacers provided, attach the bimini to the tower clamps and disconnect the boot straps so that the bimini drops to the rear. **Note: Each spacer should be positioned so that it rests against flat side of the tower clamp. This allows the eye end to rotate freely on the thumb screw.**
5. Unzip the boot and deploy the bimini. Pivot the bimini upward to install the adjustable hold-straps located at each corner of the Bimini Top.
6. Mark the position of the eye straps on the gunnel of the boat, measuring to make sure they are exactly opposite each other on each side of the boat. The position of the eye straps should be such that 45 to 90 degree angles are formed with the front and rear bow (a wide letter "M" as shown) when the hold-down straps are secured. Be sure to leave room for strap adjustment!
7. Use a drill with a 9/64" bit to drill the pilot holes for the eye straps. When drilling into fiberglass, be sure to hollow out the pilot holes slightly with the drill bit. Secure the eye straps with the No. 10 x 1" sheet metal screws provided. Attach the hold-down straps to the eye straps.
8. Adjust the bimini to the desired position by adjusting the front and rear hold-down straps. Make sure the canvas is as taut as possible to prevent loose fabric from whipping in the wind.
9. If you ordered brace options with your tower bimini, the braces are easy to adjust and install. All braces are 24" long, standard. To reduce the length of a brace, simply remove the eye end by loosening the set screw. Cut the brace to the desired length using a hacksaw and replace the eye end. Fasten the hinged jaw slide to the frame by tightening the set screw, and secure the eye end to the bolt on the jaw slide. Attach the opposite end of the brace to the tower with the tower clamp, spacer and thumb screw (refer to step 5), thumb screws toward the inside of the boat.



Tower Bimini, Stored Position



Placement of the hold-down straps should form the letter "M". Straps should form a 45 to 90 degree angle with each bow.



Optional braces are easy to adjust and install.



## Carver by Covercraft® Limited Warranty

The materials and workmanship in Carver products are guaranteed to be free of defects at time of manufacture. The length of the warranty is determined by the type of material ordered. Please visit our website, [www.carvercovers.com](http://www.carvercovers.com), for more information on length of warranty for each of our Bimini Top fabrics.

Warranty coverage commences on the original date of purchase. The warranty does not cover normal wear, weather soiling, stains from environmental pollution and/or standing water, cuts from sharp objects, neglect, accident or misuse. The Bimini Top must be properly installed, utilized and maintained.

If a defect is detected within 12 months of date of purchase, Carver will repair or replace (at its discretion) the product free of charge.

If a defect is detected after 12 months and up to 36 months from date of purchase for three-year warranties, and up to 60 months from date of purchase for five-year warranties, Carver will (at its discretion) repair the defect on a time and material cost basis or replace the product on a pro-rated basis.

Carver and/or seller provide this warranty in lieu of all other warranties, expressed or implied. Carver and/or seller disclaim all liability for special, incidental or consequential damages.

Some states/provinces do not allow limitations on how long implied warranty lasts, or the exclusion or limitation of special, incidental or consequential damages, so these limitations and exclusions may not apply to you. This warranty gives you specific legal rights. You may also have other rights which vary from state/province to state/province.

**Call before returning product to receive a Return Merchandise Authorization Number (RMA#), then send warranty claims to:**

**Phone: (888) 48-COVER**

**Mailing/Shipping Address: Carver by Covercraft, 212 N. Lyles Ave., Landrum, SC 29356**

Please enclose a note describing the defect and be sure to include your full name and address inside the package.



Please take extra care when unpacking and assembling your Bimini Top. Should you need to return the Bimini Top, it **MUST** be in its original, new condition. The Bimini Top canvas must be clean and dry, and free of debris (including pet hair). Frame components must not be scratched.